

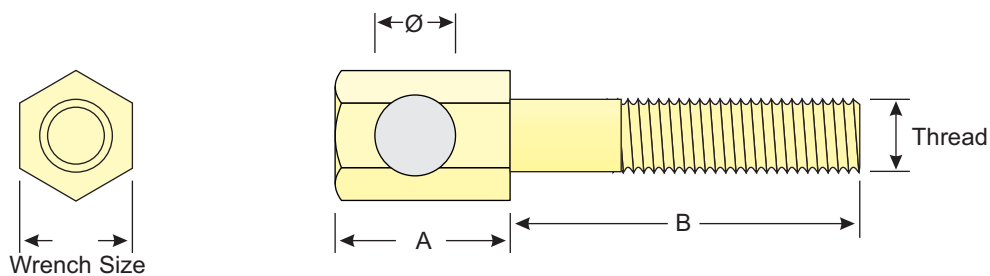

- For the suspension of rectangular ductwork with threaded rods.
- The rectangular flange joint is made with the Hanger Bolt which has an extended head and a clearance hole for the support rod, and therefore enables the duct to be supported at its strongest point.
- Sturdy and economical solution for connecting ductwork to threaded rods.
- Easy installation.

DIMENSIONS AND LOAD-BEARING CAPACITY



Hanger Bolt type	for flange profile	for threaded rod	loading capacity*	A mm	B mm	Wrench size in mm	Thread	Ø mm
AB M 8 - 9	20 mm hoch	M8	1500 N	20	25	13	M8	9
AB M10 - 9	30 mm hoch	M8	2000 N	28	30	17	M10	9
AB M10 - 11	30 mm hoch	M10	2000 N	28	30	17	M10	11



* The indicated maximum load-bearing capacity is in accordance with the European Norm EN 12236 and can therefore be used integrally. The breaking load is three times higher.

INSTALLATION

Instead of the standard bolts and nuts two AB Hanger Bolts are fitted in the holes of the duct's bottom corner pieces. Care must be taken when tightening the bolts that the hole for the support threaded rod remains vertical.

Only the bottom holes must be used, not only because it allows adjustment of the support rod, but also for safety reasons - the bottom corners can never be pulled out from the duct.

Sound isolation: With SI or SD Isolation Hangers or DB Ceiling Brackets.

If ducts have external insulation, the supporting rods can be approximately 5 cm longer and a Long Nut (please refer to section "GS Threaded Rods/LM Long Nuts") or collar 30 mm long is installed instead of the normal nut. This enables the height of the duct to be adjusted even after it has been insulated.

DESIGNATION

Art.No.	Description
F07A-1001	AB M 8- 9 galv.
F07A-1002	AB M10- 9 galv.
F07A-1003	AB M10-11 galv.



- For the suspension of horizontally and vertically running rectangular ductwork.
- Suitable for the suspension with threaded rods or directly with plugs.
- Can be mounted either on the upper or lower corners of the duct.
- A GP Rubber Isolator provides good sound isolation.

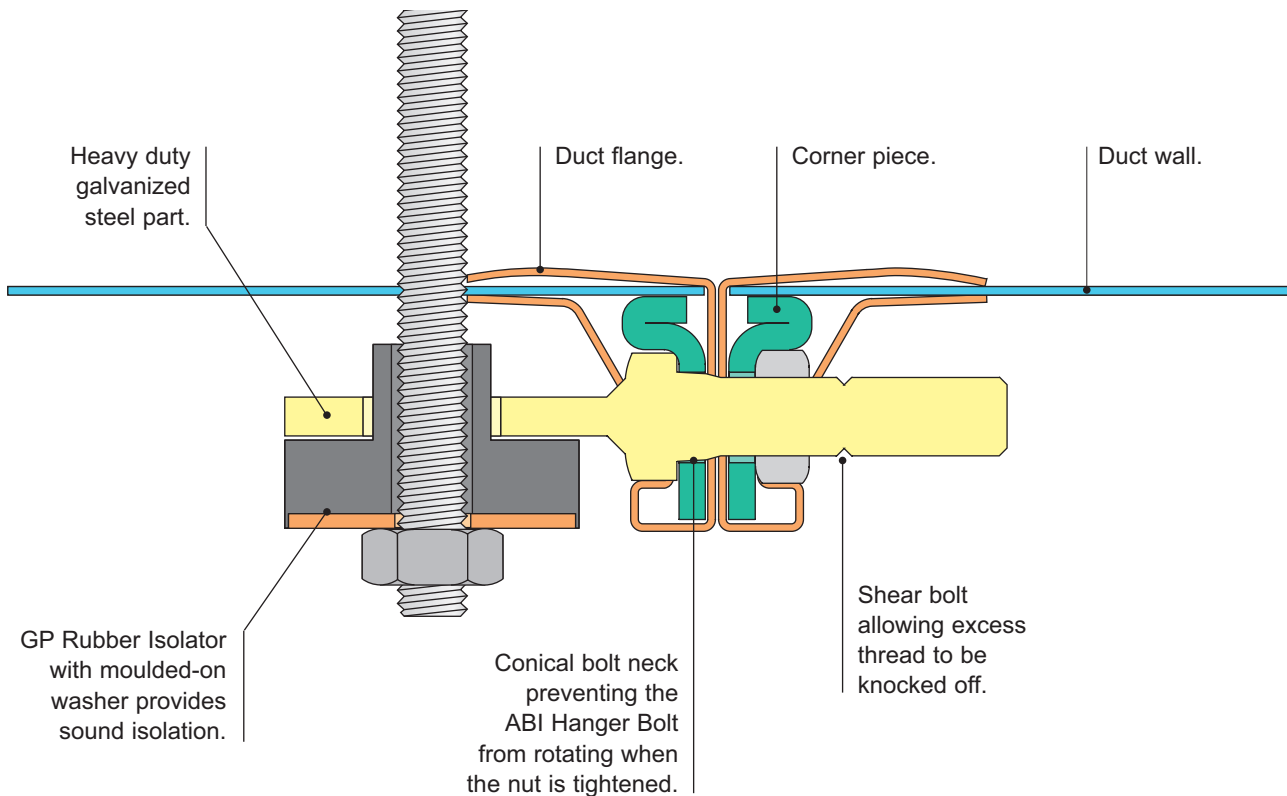

INSTALLATION

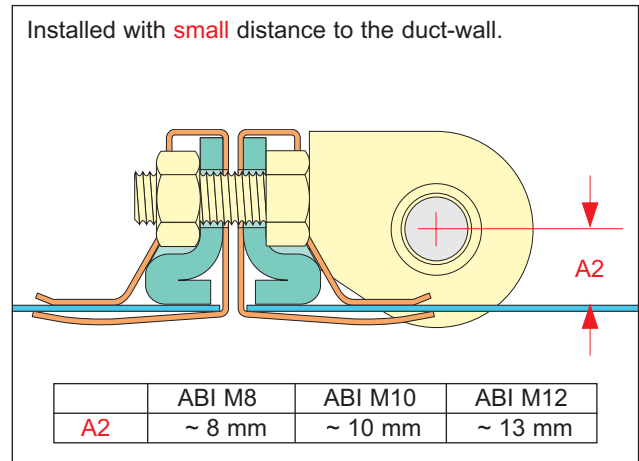
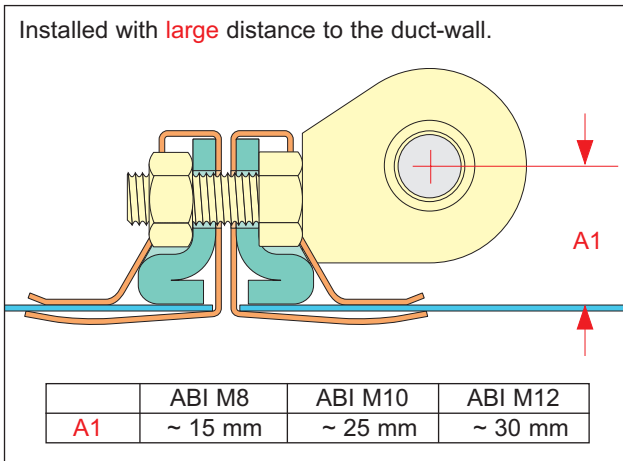

1. The ABI Hanger Bolt replaces the corner piece bolt. The long bolt barrel allows enough clearance between the two rectangular duct flanges so that the gasket between them is not compressed right away during installation, therefore easing the threading of the nut.
2. When the ABI Hanger Bolts and the bolts are installed at each corner, the ABI and the bolts can be tightened. The sequence of tightening does not matter. When tightening the ABI, turn it into the desired position and hold it tight. The conical neck will provide enough friction to prevent the ABI from rotating while the nut is being further tightened.
3. Once all ABI Hanger Bolts are installed on the flange, drop the previously fixed threaded rods through the ABI Hanger Bolt's clearance hole. Then install the Rubber Mushroom and finally secure the whole with a nut. If plugs are used (for ceiling or wall installation) a possible solution is to drill the hole through the rubber and the ABI clearance hole, insert the plug, and then tighten the bolt.

DIMENSIONS

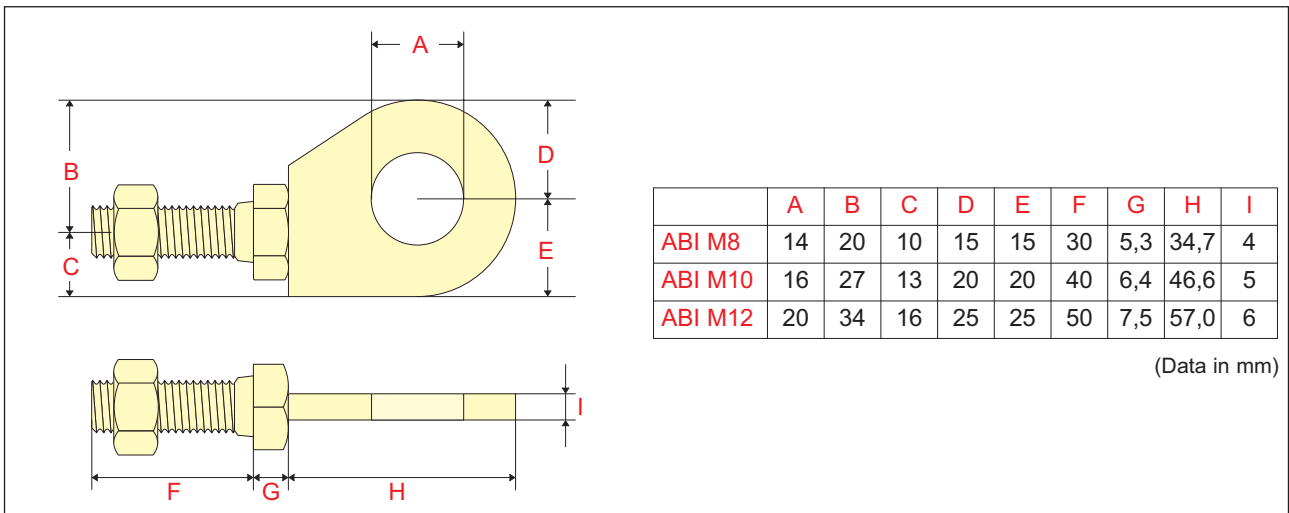

DESIGNATION AND LOAD-BEARING CAPACITY

Art.No.	Description	isolated with	loading capacity*
F07V-1010	ABI M8	Rubber Isolator GP M8	500 N
F07V-1011	ABI M10	Rubber Isolator GP M10	750 N
F07V-1012	ABI M12	Rubber Isolator GP M12	1000 N



* The indicated maximum load-bearing capacity is in accordance with the European Norm EN 12236 and can therefore be used integrally. The breaking load is three times higher.

More information concerning the GP Rubber Isolators can be found in the section „GP Rubber Isolator/GR Rubber Ring“.